

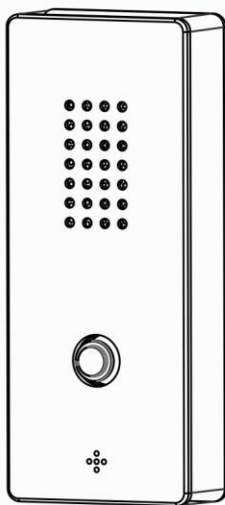

INTERCOM PANEL

Installation Manual



Interface description

Front

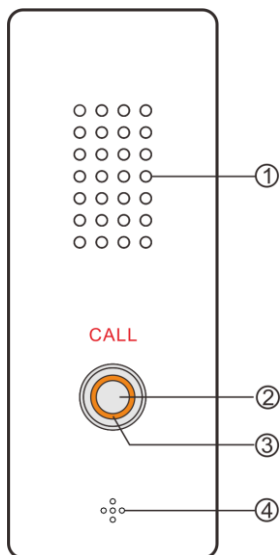

① Speaker: restore the remote voice.

② Call button:

Press the button to call to the server software designated terminal.

③ Status indicator light.

The indicator light will fast flash within the conversation; And the indicator light is normal on when it's free.

If intercom terminal and server connection is abnormal, the indicator light will be slowly flash.

④ Pickup microphone: collect the local site voice.

Back

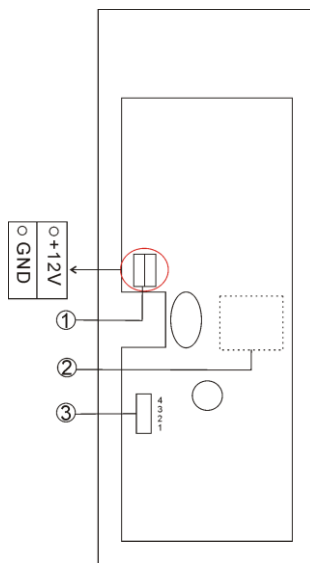

① Power input interface:

DC12V/3.3A (This interface is only used in independent power supply mode)

Tips: pay attention to the direction of power supply, Do not reverse power supply direction

② For connecting panel splitter, using 568B network cable

③ Dial switch.

Dial switch operation

Panel ID No.	The 1 st dial code	The 2 nd dial code	The 3 rd dial code	The 4 th dial code
1 #	ON	ON	ON	ON
2 #	1	ON	ON	ON
3 #	ON	2	ON	ON
4 #	1	2	ON	ON

5 #	ON	ON	3	ON
6 #	1	ON	3	ON
7 #	ON	2	3	ON
8 #	1	2	3	ON
9 #	ON	ON	ON	4
10 #	1	ON	ON	4
11 #	ON	2	ON	4
12 #	1	2	ON	4
13 #	ON	ON	3	4
14 #	1	ON	3	4
15 #	ON	2	3	4
16 #	1	2	3	4

For example: The dial position shown in the below picture , after searching from the above chart , we can know the panel 's ID is 13#.



Note: The intercom panels which connect to the same one IP intercom terminal can't use the same ID.

Appearance installation dimension (Unit : mm)

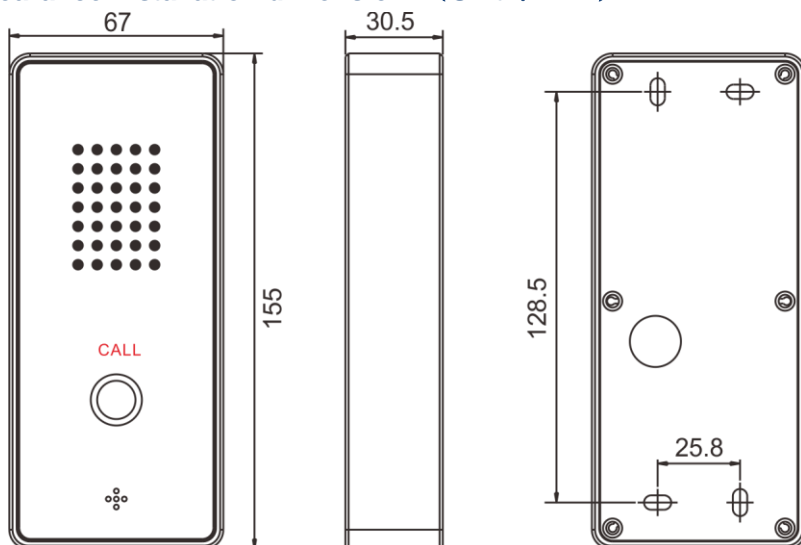

Installation diagram

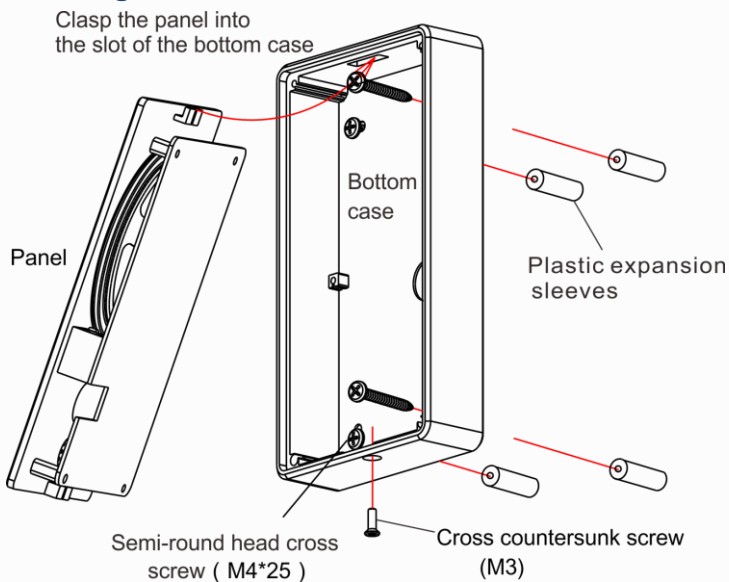

Packing list

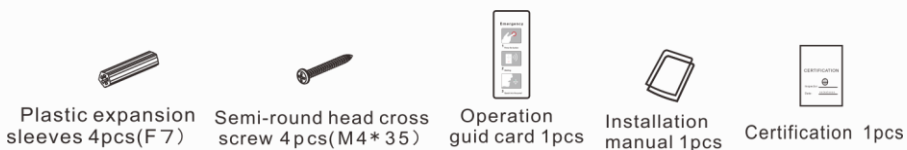

Wechat

SPON Communication Technology Co., Ltd.
www.spon.com.cn
Service Hotline: +86-400-823-2588
Reserve the amendment right without notice



V1.0B200917